

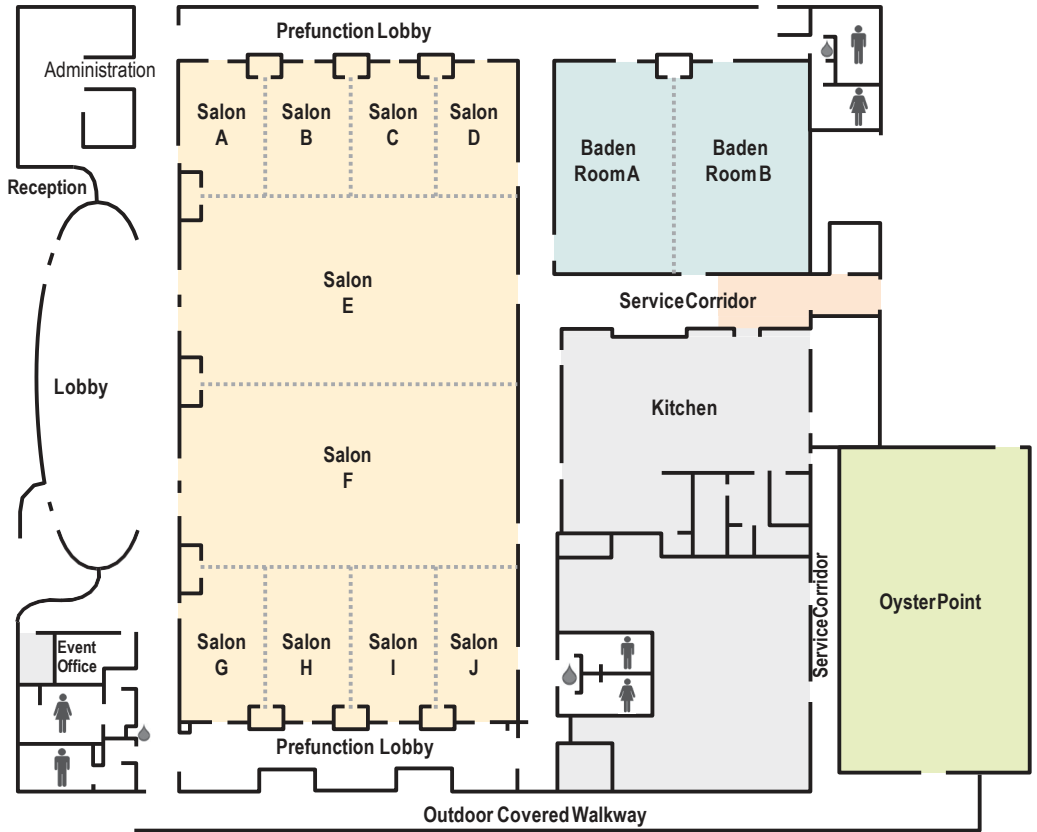

**SOUTH SAN FRANCISCO  
CONFERENCE CENTER**

255 South Airport Boulevard  
S. San Francisco, CA 94080  
Phone: (650) 877-8787  
Fax: (650) 877-5356  
URL: [www.ssfconf.com](http://www.ssfconf.com)  
E-mail: [hotline@ssfconf.com](mailto:hotline@ssfconf.com)



**MEASUREMENTS IN FEET**

Room Name	Approximate Dimensions	Approximate Square Feet	Ceiling Height	8' x 10' Exhibits	10' x 10' Exhibits	Theater	Reception	Suggested Capacities		Hollow Square	U Shape
								Banquet	Classroom		
Grand Ballroom	84' x 162'	13,500	13	81	72	1,200	1,200	850	700	-	-
Salon A-E or F-J	84' x 81'	6,750	13	40	34	680	690	420	310	-	-
Salon E or F	84' x 46'	3,750	13	20	15	400	390	250	180	80	70
Salon A-D or G-J	84' x 35'	3,000	13	13	14	300	300	180	120	70	60
Salons A-C; B-D; G-I or H-J	63' x 35'	2,250	13	-	-	200	220	110	85	55	45
Salons A-B; C-D; G-H or I-J	42' x 35'	1,500	13	-	-	150	150	80	55	35	25
Salons A, B, C, D, G, H, I or J	21' x 35'	750	13	-	-	60	60	40	25	20	15
Baden Room	51' x 58'	3,000	13	15	14	300	300	190	130	60	50
Room A	51' x 29'	1,500	13	-	-	160	150	90	70	45	35
Room B	51' x 29'	1,500	13	-	-	160	150	90	70	45	35
Oyster Point	80' x 50'	4,000	15	25	20	450	400	270	200	80	70

**MEASUREMENTS IN METERS**

Room Name	Approximate Dimensions	Approximate Sq. Meters	Ceiling Height
Grand Ballroom	25.6 x 49.4	1,264	4.0
Salon A-E or F-J	25.6 x 24.7	632	4.0
Salon E or F	25.6 x 14.0	358	4.0
Salon A-D or G-J	25.6 x 10.7	273	4.0
Salons A-C; B-D; G-I or H-J	19.2 x 10.7	205	4.0
Salons A-B; C-D; G-H or I-J	12.8 x 10.7	136	4.0
Salons A, B, C, D, G, H, I or J	6.4 x 10.7	68	4.0
Baden Room	15.5 x 17.7	275	4.0
Room A	15.5 x 8.8	137	4.0
Room B	15.5 x 8.8	137	4.0
Oyster Point	24.4 x 15.2	372	4.6